

Product Information/Specification Sheet

Studor Maxi-Filtra (Active Carbon Filter designed to eliminate bad odours produced by the drainage system)

Description

The Studor Maxi-Filtra is an active carbon filter designed to eliminate bad odours produced by the drainage system. For use externally, it operates as a 2-way vent, filtering air in both directions. Particularly for use with septic tanks, the Maxi-Filtra may also be installed on open vents already existing or for new buildings where regulations insist on their inclusion within the building's drainage system.

For best results, the Studor Maxi-Filtra should be installed with Studor Air Admittance Valves (AAVs).

Features

- Replaceable carbon filter cartridge.
- Prevents the release of foul air from the drainage system.
- Requires no specialist installation.
- Available in black ABS.

Installation

- The Maxi-Filtra should be connected to the piping in accordance with Studor's installation instructions.

Applications

The Maxi-Filtra may be installed externally anywhere when the odour from existing vents present a problem, or when pipe vents are to be included in the drainage system of a new build:

- Septic tanks
- Grease separators
- Rain water tanks
- Sewage treatment plants
- Lifting equipment*
- Building drainage open vents*

* in conjunction with Studor AAVs of an appropriate airflow

Aluminium Cover (optional)

The Aluminium Cover provides increased protection to the Maxi-Filtra when it is installed outside. The cover is placed over the upper half of the polystyrene cap provided and secured in place with adhesive tape. This provides increased protection from animals/ birds and the environment, i.e. inclement weather and the sun's ultra-violet rays.

Warranty

The Studor products have a 10 year warranty period. Visit www.studor.net for full details.

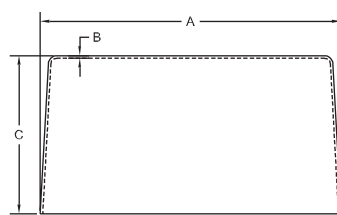

Aluminium Cover

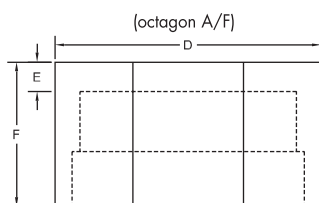

Insulating Cap

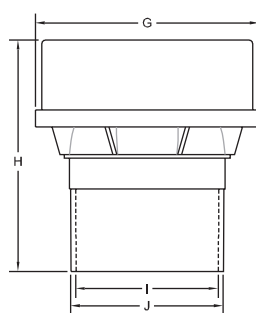

Maxi-Filtra

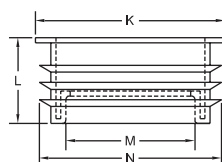

Connector

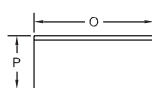

Cartridge

Dimensions

Dimension	Metric (mm)	Imperial (inches)
A	Ø 175	6 7/8
B	1.5	1/8
C	92	3 5/8
D	155	6 1/8
E	17	11/16
F	84	3 5/16
G	Ø 130	Ø 5 2/16
H	131	5 5/16
I	Ø 83	3 1/4
J	Ø 89	3 1/2
K	Ø 111	Ø 4 3/8
L	50	2
M	Ø 75	Ø 2 15/16
N	Ø 106	4 3/16
O	Ø 70	Ø 2 3/4
P	31	1 1/4

Note: Dimensions for reference only

Performance parameter

Temperature range	-20°C to +60°C (CE) -40°F to +150°F (ASSE)
-------------------	---

Airflow Capacity

Pressure (Pa)	Flow Rate (l/s)
100	2
250	5
500	8

Materials

Component	Material
Aluminium cover	Aluminium
Insulating cover cap	Polystyrene
Maxi-Filtra body	ABS
Connector	Rubber
Cartridge	Activated carbon

Pipe sizes

Europe	AU/NZ	USA
DN 75-110	DN 80-100	3" - 4"